

## **GALILEO CHL ISO 75xL**

### Fissaggio telescopico per cemento

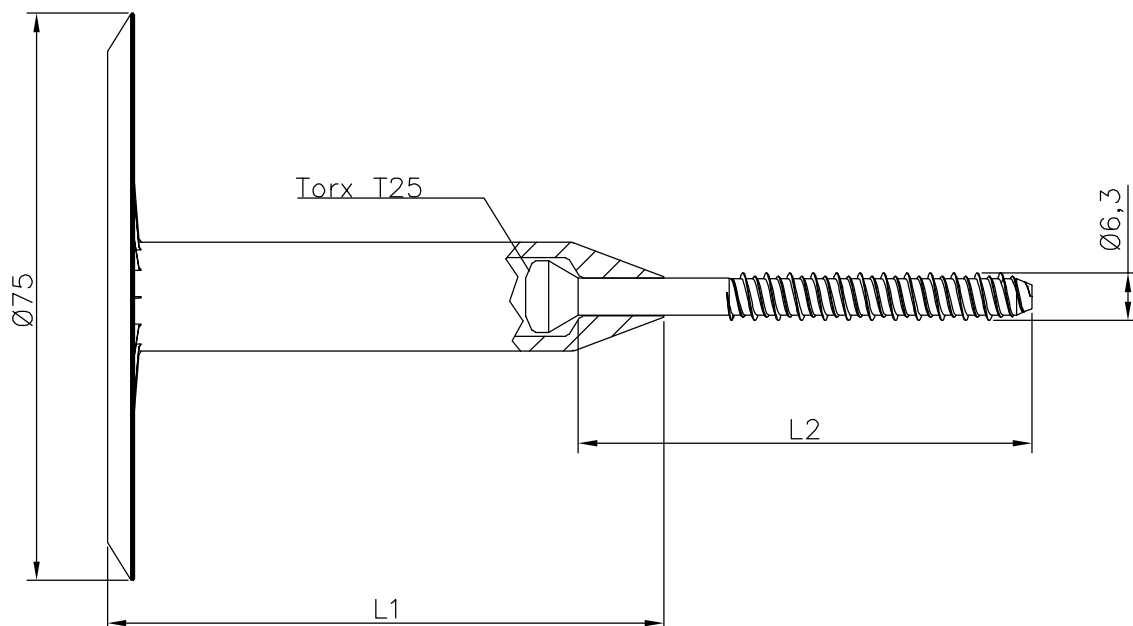

MATERIALE: Acciaio C18 (Vite) - Polipropilene (canotto)  
TRATTAMENTO: Carbonitrurazione  
RIVESTIMENTO: Lanthane

SCALA: 1:1  
FIRMA: Alberto B. T.  
DATA: 28/02/2019



**Rottura  
in Trazione**

**17100 N**

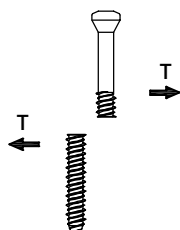

**Rottura  
al Taglio**

**1000 N**

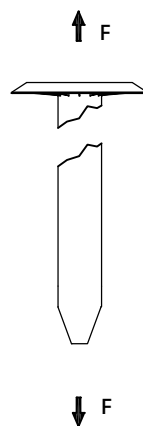

**Rottura  
in Trazione**

**1740 N**

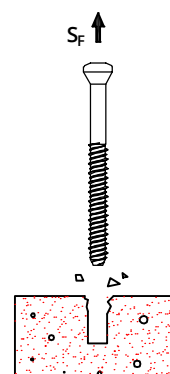

**Sfilamento da CLS  
prof. foro 30 mm**

Rck 30      Sf  
**3300 N**

N=Newton 1N ~ 0.102 kgf - I valori indicati rappresentano il valore caratteristico derivante dalle diverse sessioni di prove